

concurso / memorial a martin luther king

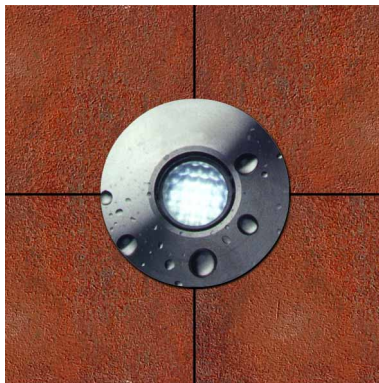

marcelo aguiar - lius rocca

a place of celebration

Unbalanced plane.
Surface in dynamic tension.
Existential area to commemorate a tough yet brilliant life.
The order in the illuminated grid is disrupted by bright spots that stand out following a superior logical pattern.
The transparent partition facing north records the milestones of his life, that seem to float - an unfading, ethereal presence.
Death - a gap in the structure emerges in the form of light.
A beacon,
the eternal memory of the principles of equality.
Shining in the darkness, it illuminates the night as an everlasting guide.
Blended into the day sky, unperceived in daylight, it still constitutes an harmonious presence.

individual walkway

Meditation.
Free, personal experience.
Winding path lined with lateral seats to create *spiritual and emotional anchors*.
Connection with the existing walkways and Tidal Basin Promenade, among the existing *cherry trees*.
Prominence is given to the landscape.

a place of contemplation

A sheltered gallery.
A path slightly elevated from the ground.
Sheltered, human-size area.

dr. martin luther king jr. memorial

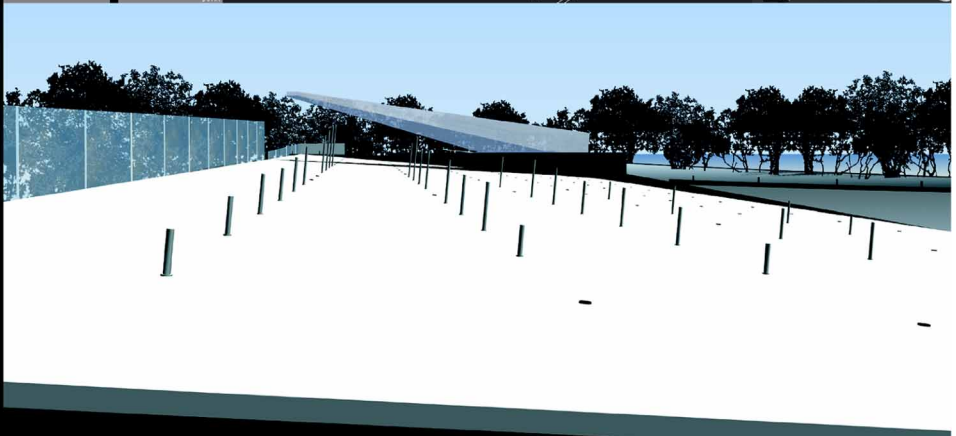
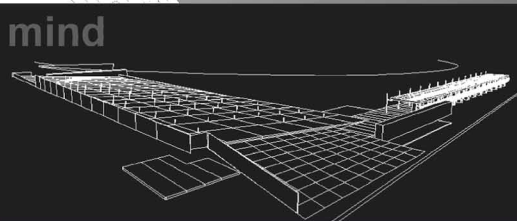
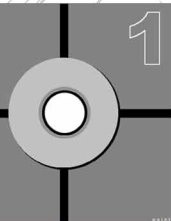
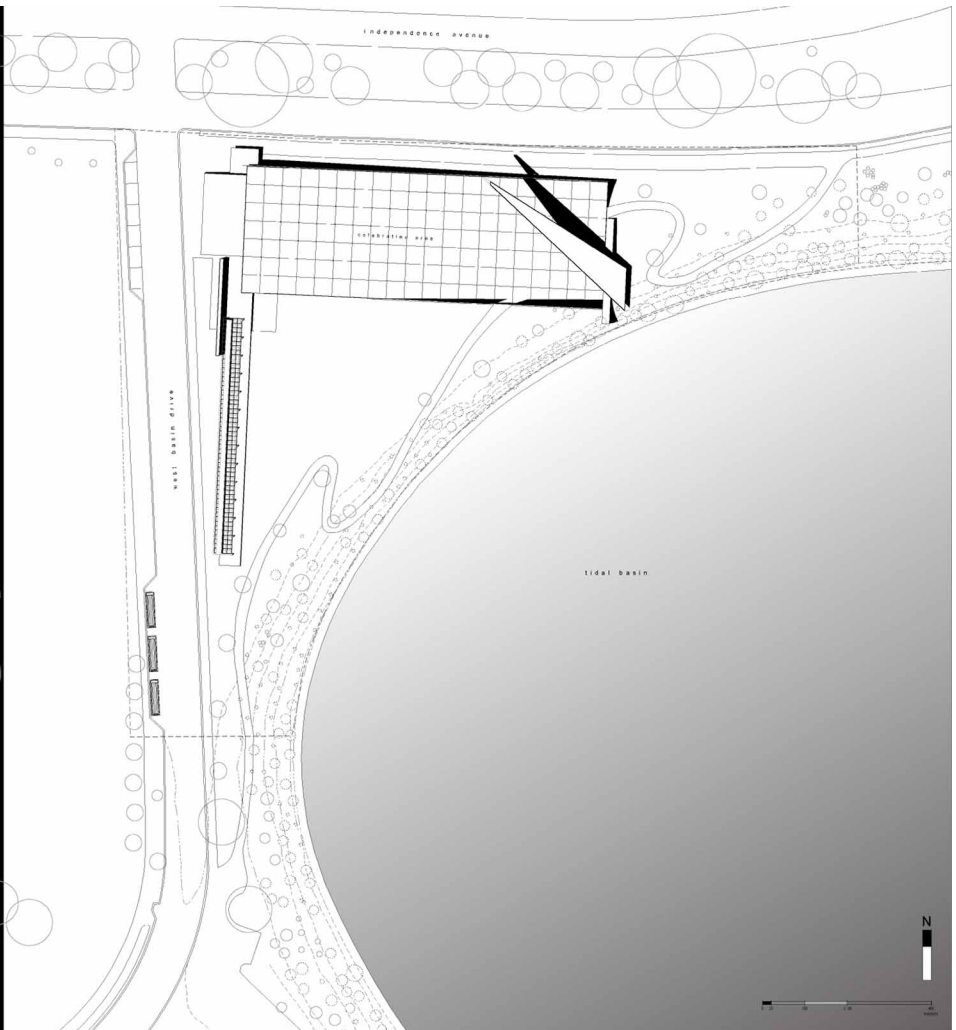

materials

the everlasting presence of granite	a significant glance at eternity	1000 stone panels (casted) cast in situ
the warmth and quality of wood	a pleasant stroll presence of the natural and the portable	1/2" of natural pine wood
iron resulting from man's labor	the endurance and suffering of a singular man	1/2" x 1/2" x 1/2" steel plate (smooth) (cast) ready
high-tech glass and stainless steel	clarity of ideals and strength of a universal message	1000x1000 clear double glazed glass (with stainless steel) 1/2" x 1/2"
lucency and transparency of glass	presence in a life of service and sacrifice	1000x1000 clear double glazed glass (with stainless steel) 1/2" x 1/2"

view 1

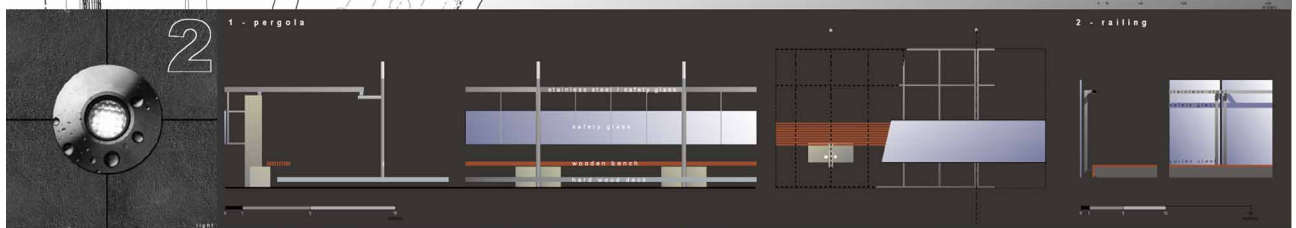
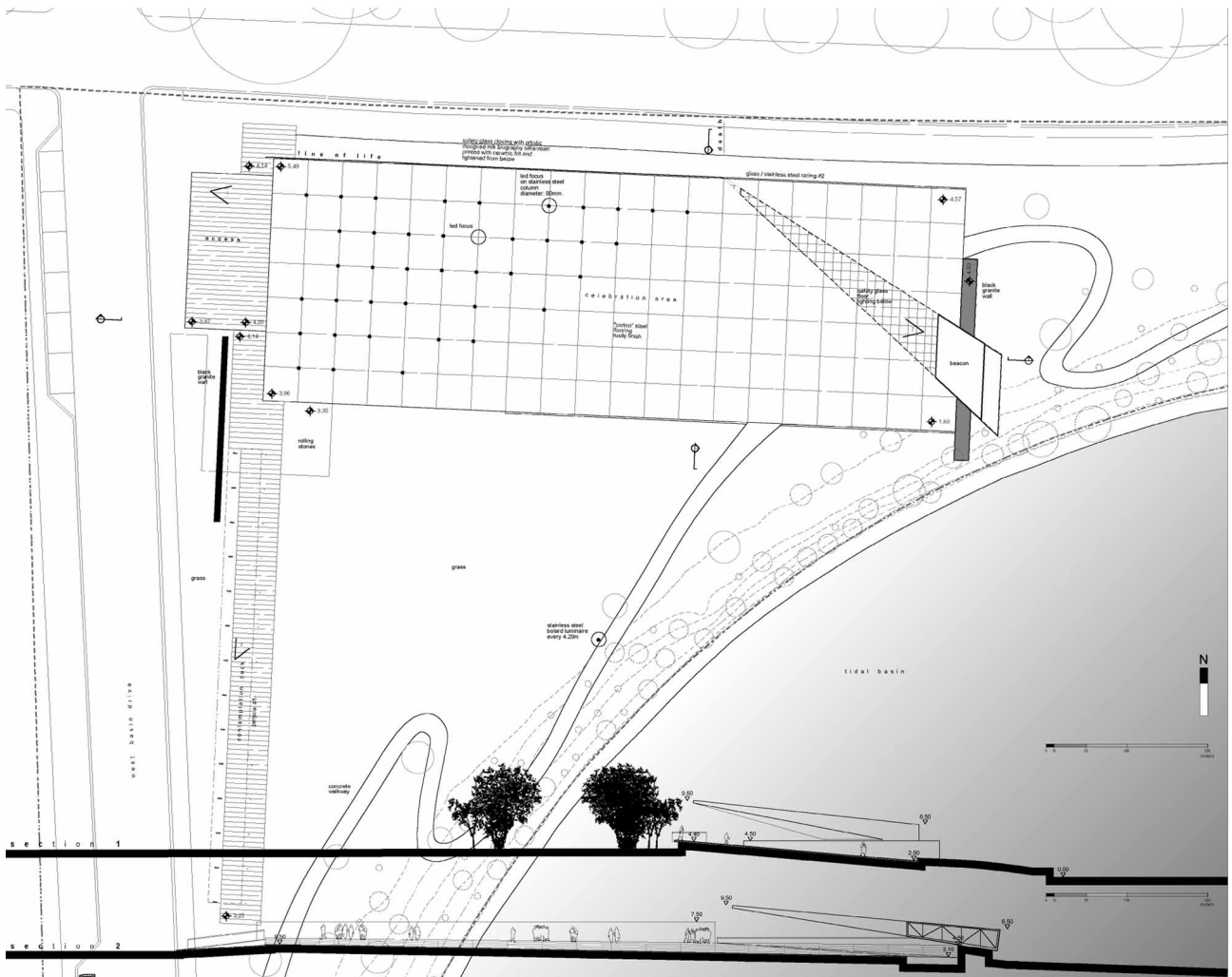

view 2

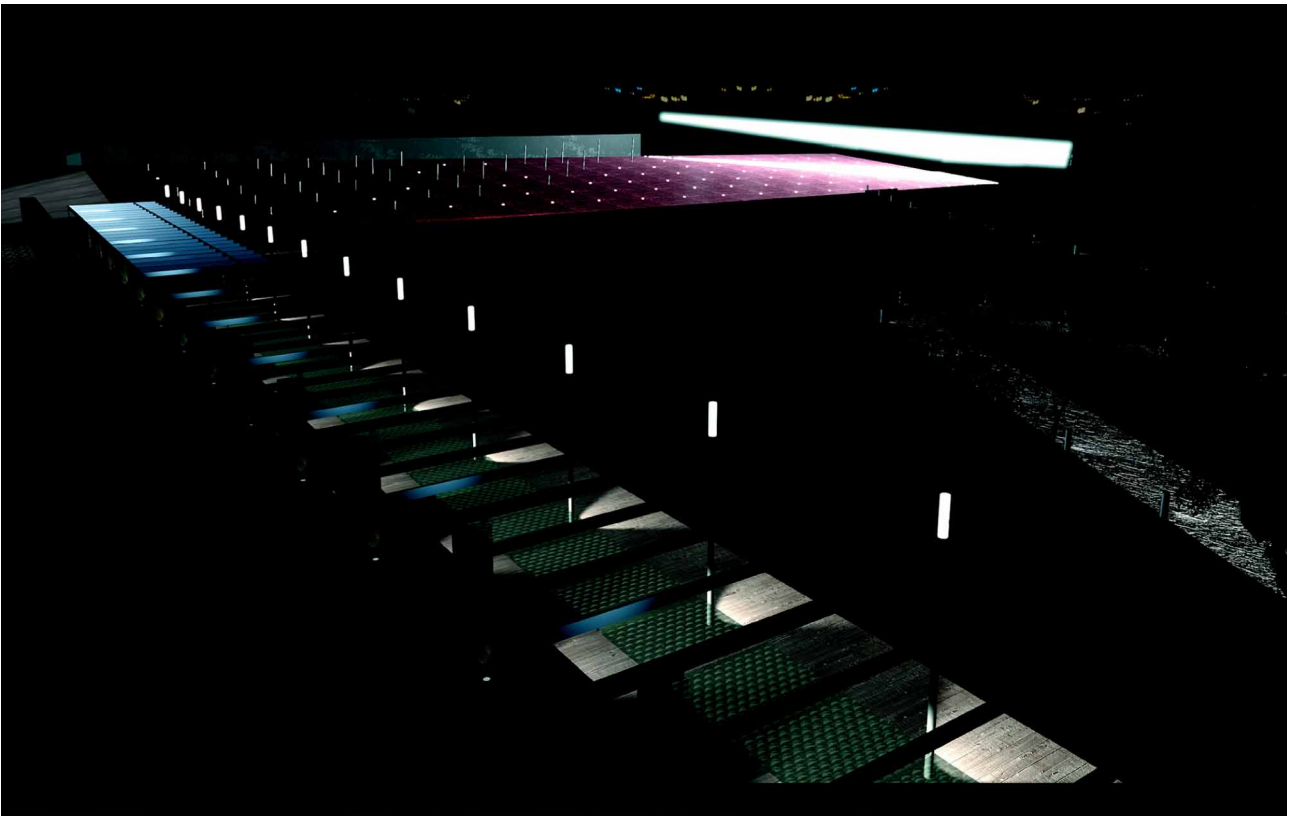

east elevation



north elevation



the challenge

to find a new landmark in the landscape that, through a purposeful forced implantation, becomes both violent and desirable.



view 3

vista 1

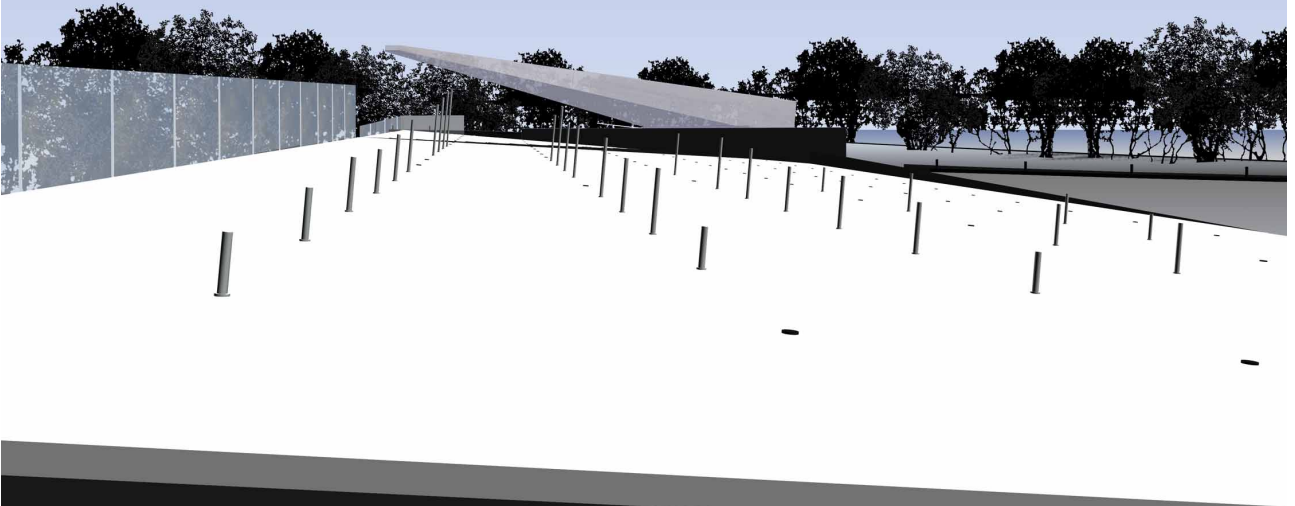

vista 2

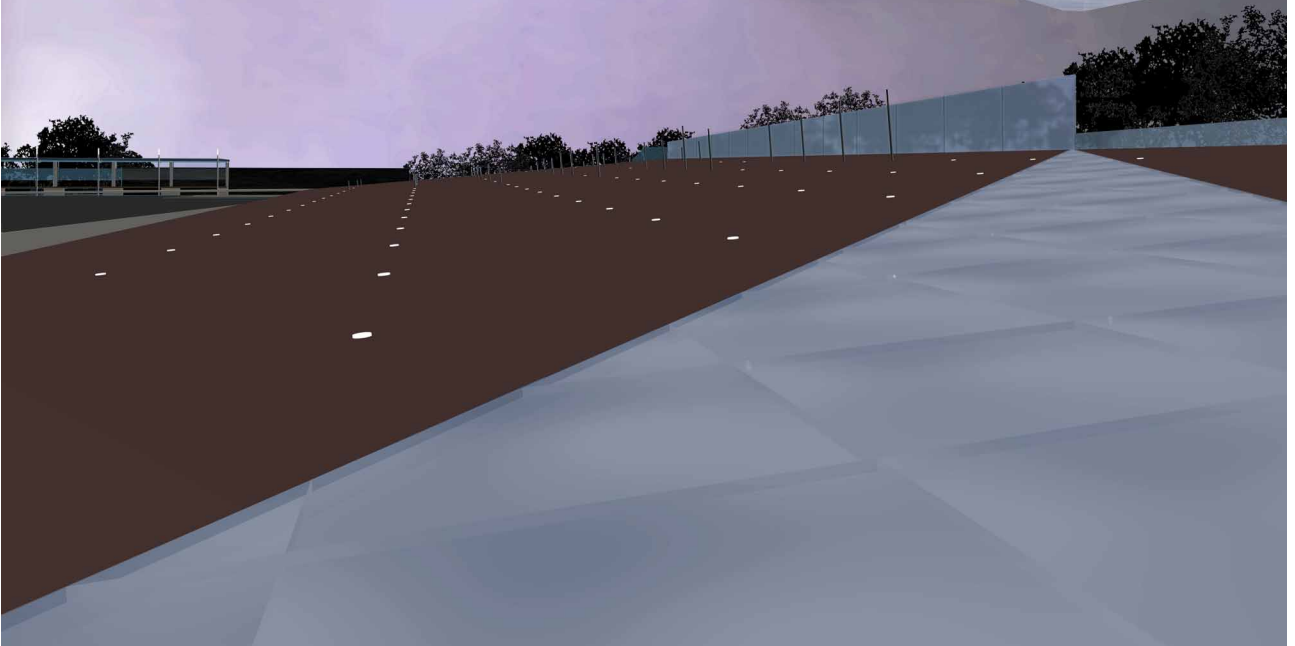

vista 3

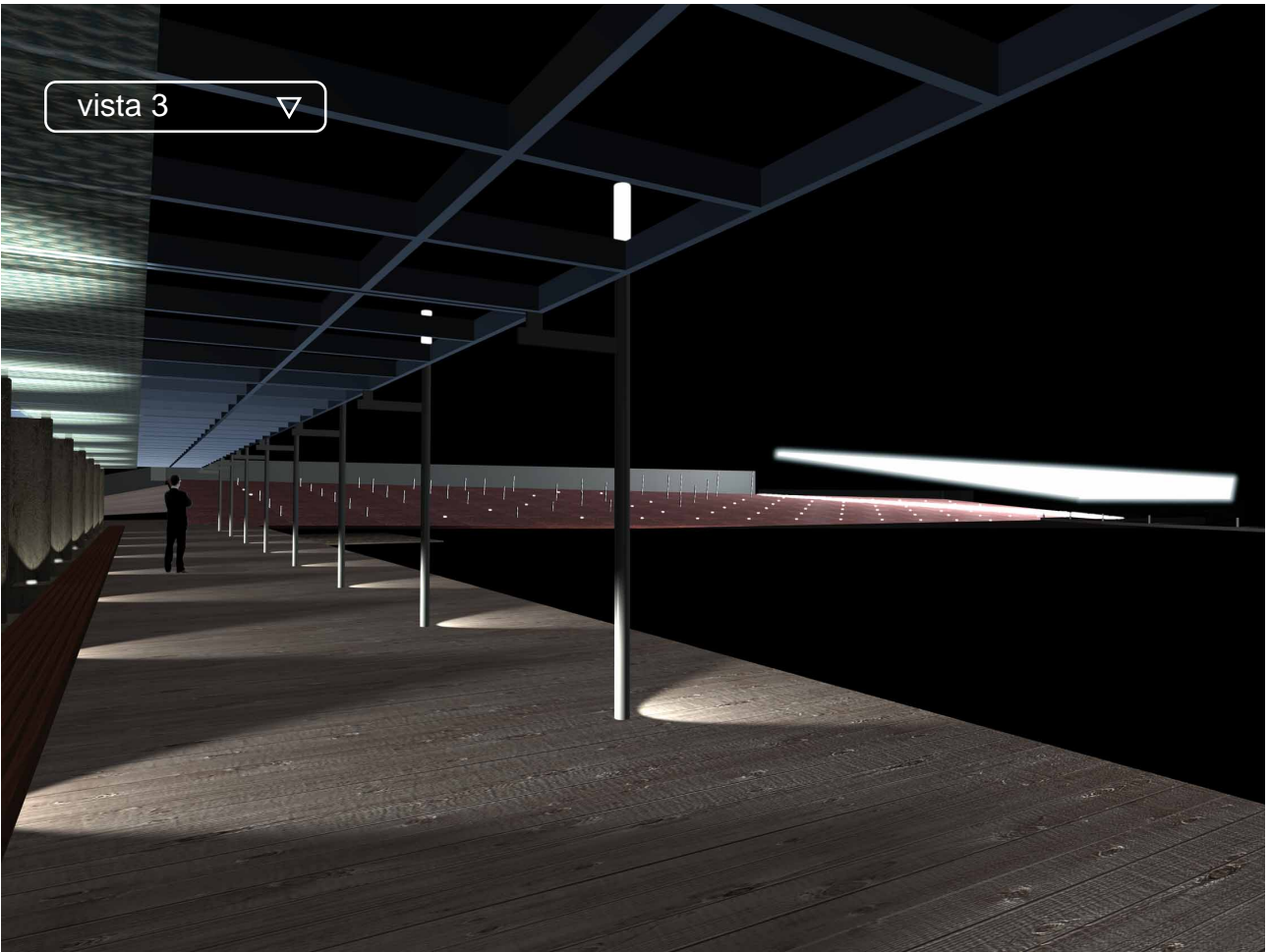

vista 4

